

Assembly method for a table with legs

Principe d'assemblage d'une table à pattes

Procedimiento de ensamblaje de una mesa con patas

 Do not climb on the table.
Risk of serious injuries.
Ne pas monter sur la table.
Risque de blessures graves.
No treparse sobre la mesa.
Riesgo de herirse gravemente.

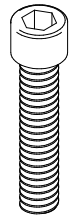

a 8 x

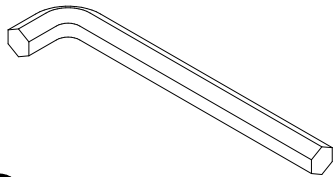

b 1 x

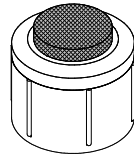

c 4 x

1

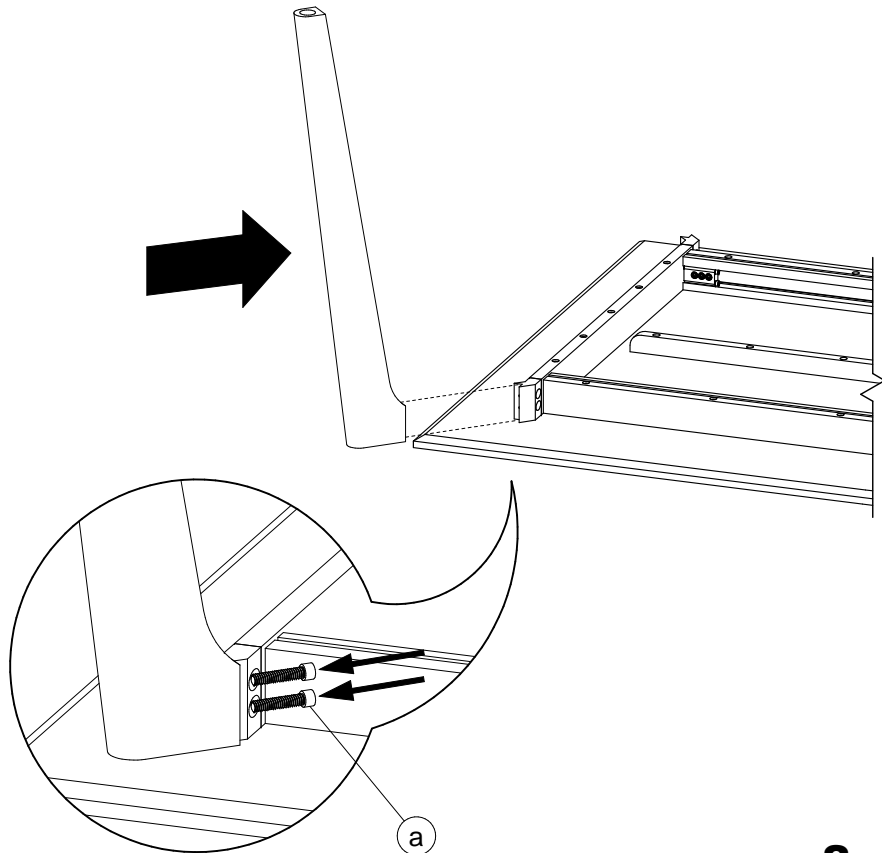

8 x

2

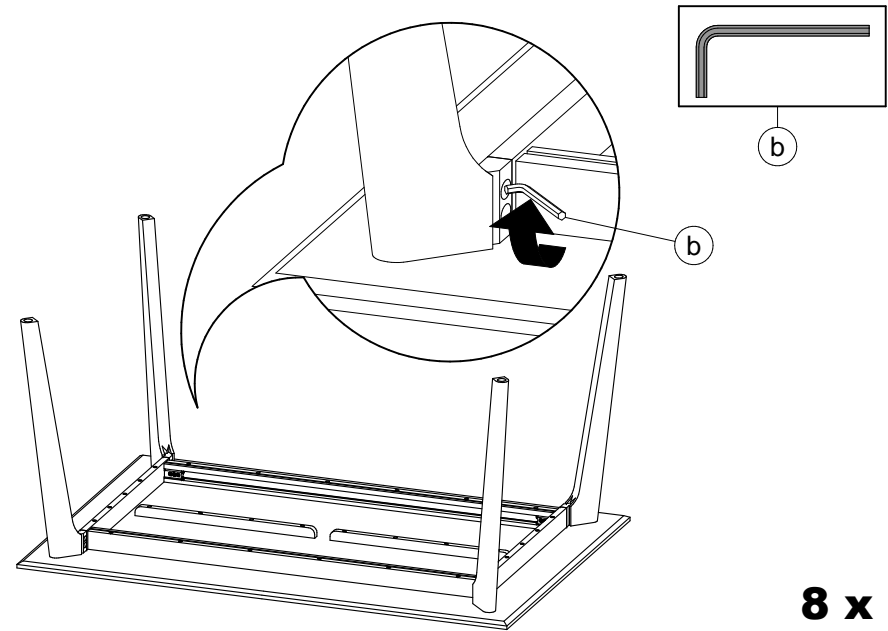

8 x

3

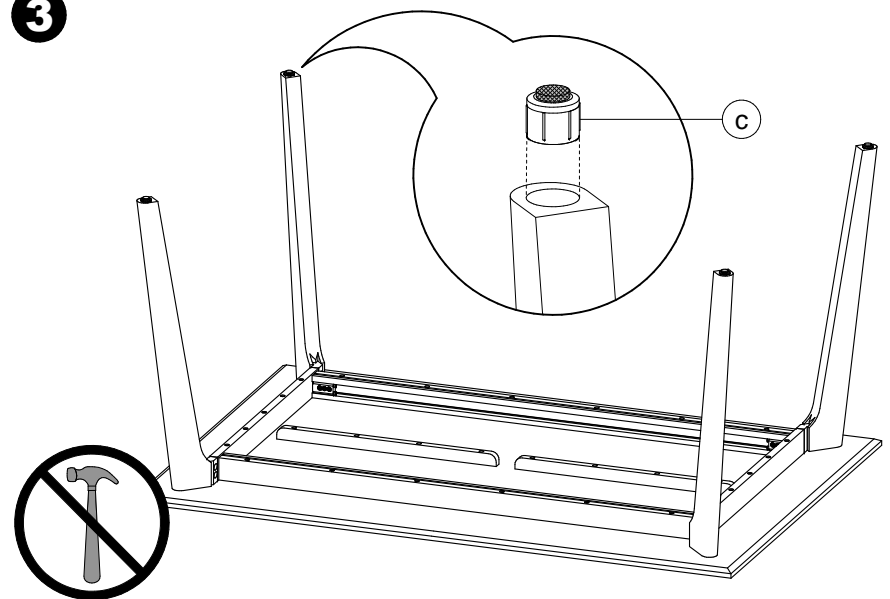

4 x

CODE PRODUIT SAC:	QUI2SACZ088		
CODE PRODUIT INFO-CLIENT:	FOP2INZTAB-1088 (À INCLURE DANS LE SAC)		
REVISION:	P00		
NO	DESCRIPTION	NOM	QTÉ
1	BOLT MÉCANIQUE 5/16-18X1 1/2 Lg.	FOAVISZBC5-16-18X1 1-2	8
2	FOACLEZALLEN6MMX2 7-8ALU 55	FOACLEZALLEN6MMCOUPEE	1
3	FEUTRE PÖTTKER ENCASTRÉE Ø25 X16mm N°:16099	QUIACCZSPATTE16099	4

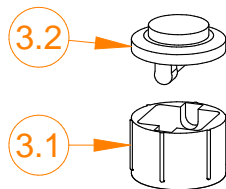
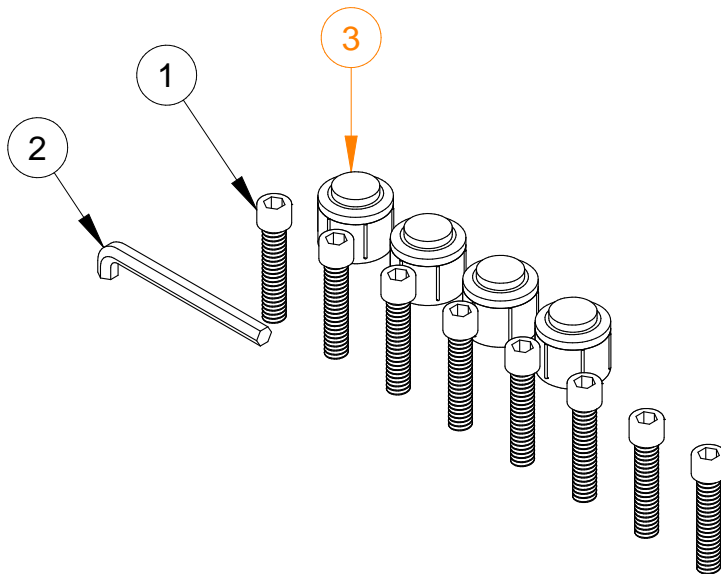

SOUS-COMPOSANTES QUIACCZSPATTE16099			
NO	NOM	DESCRIPTION	QTÉ
3.1	QUIACCZROULETTE16086C AI	CAISSON	4
3.2	QUIACCZSPATTE16100AD	FEUTRE	4

**** PARTICULARITÉ POUR CES ENSEMBLES:**

VOUS DEVEZ COMMANDER L'ENSEMBLE QUI ARRIVE EN SOUS-COMPOSANTES. LES PRÉ-ASSEMBLER ET LES METTRE DANS LE SAC SELON LES QUANTITÉS DEMANDÉES PLUS HAUT.