

**Assembly method for a pedestal table**  
**Principe d'assemblage d'une table à base**  
**Instrucciones de ensamblaje de una mesa con base**

**CP**

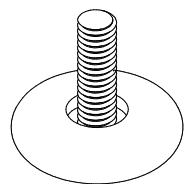

Do not climb on the table.  
 Risk of serious injuries.  
**Ne pas monter sur la table.**  
**Risque de blessures graves.**  
 No treparse sobre la mesa.  
 Riesgo de herirse gravemente.



**a** 4 x

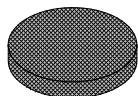

**b** 4 x



**c** 16 x



**d** 16 x



**e** 16 x

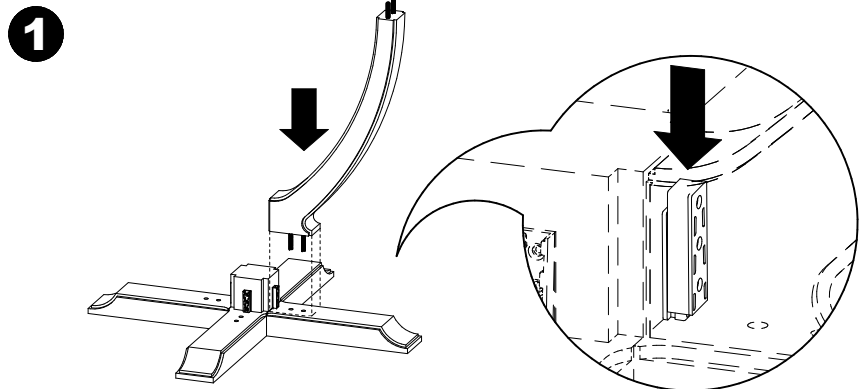

**4 x**

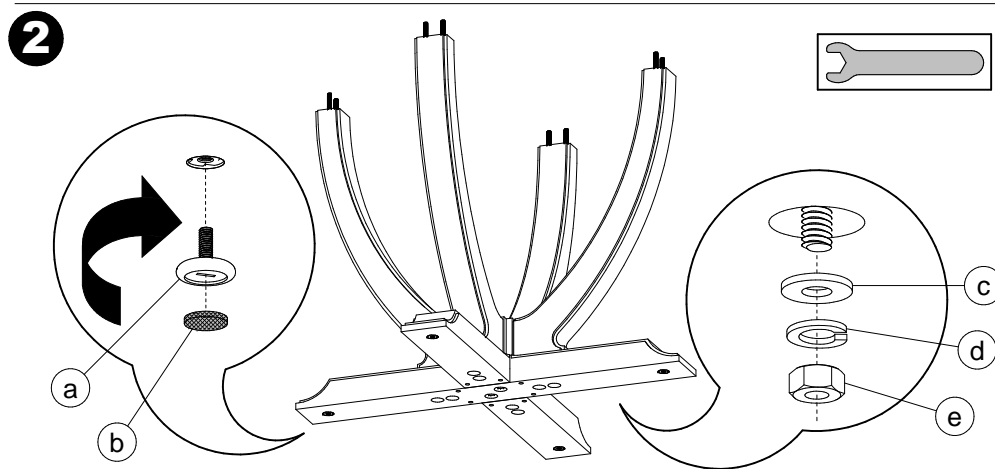

**4 x**

**8 x**

**3**

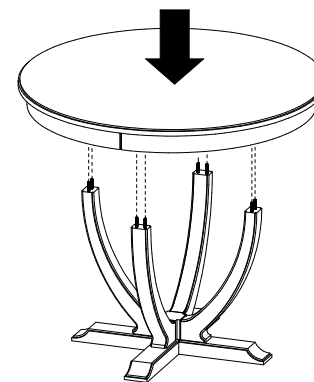

**4**

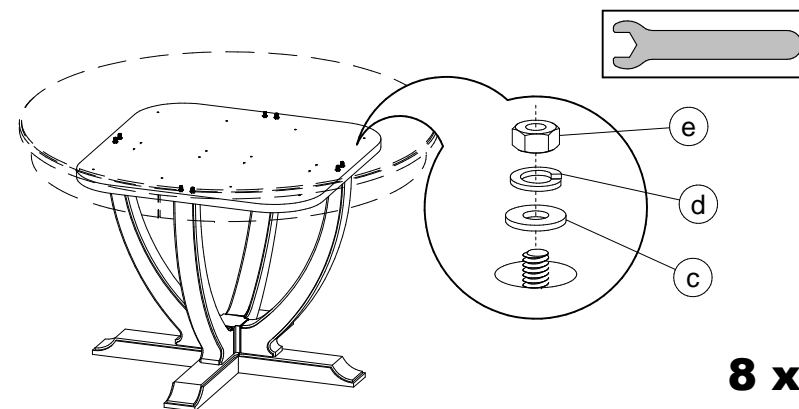

**8 x**

**5**

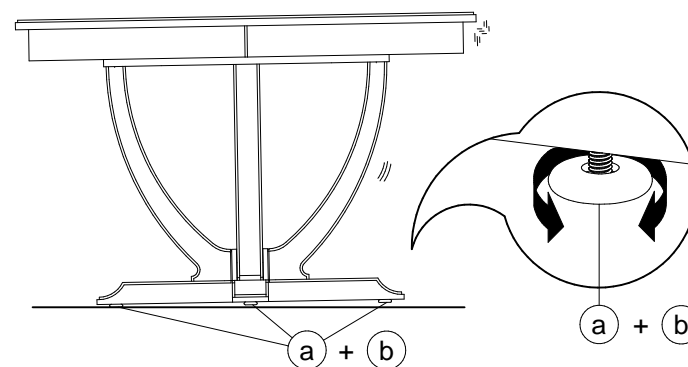

**a + b**

**a + b**

# Assembly method for a pedestal table

## Principe d'assemblage d'une table à base

### Instrucciones de ensamblaje de una mesa con base

**CQ**



Do not climb on the table.  
Risk of serious injuries.  
**Ne pas monter sur la table.**  
**Risque de blessures graves.**  
No treparse sobre la mesa.  
Riesgo de herirse gravemente.

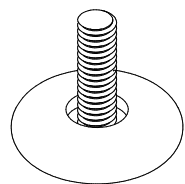

**a** 4 x

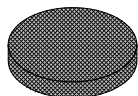

**b** 4 x



**c** 16 x



**d** 16 x



**e** 16 x

**1**

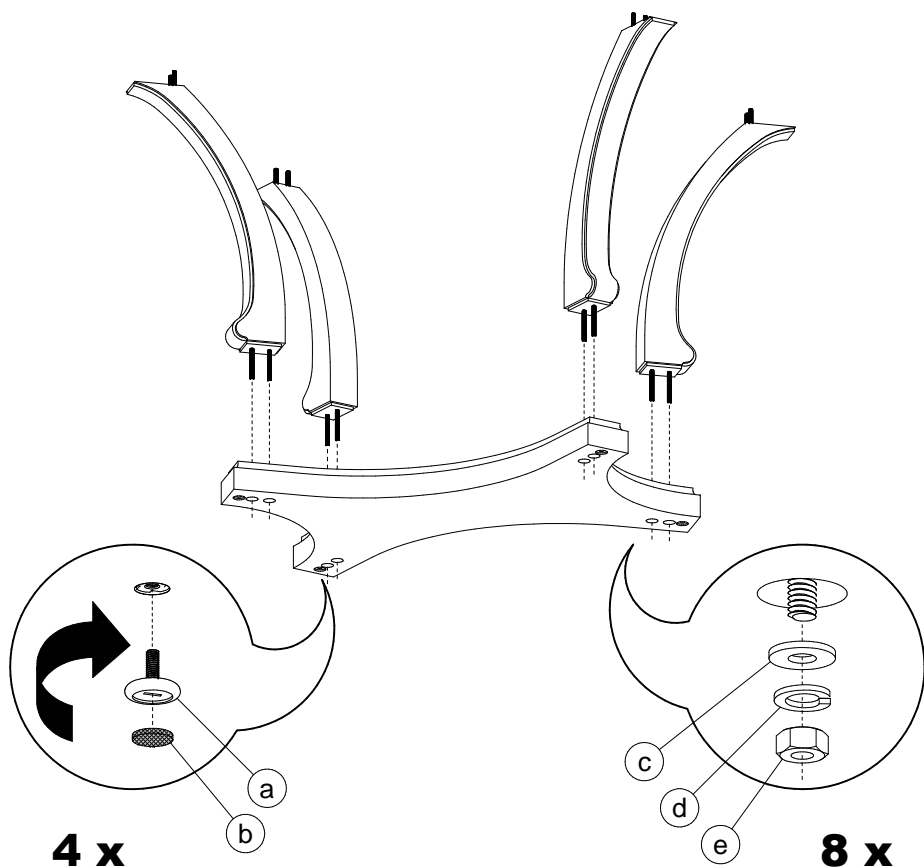
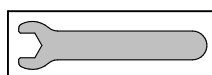

**2**

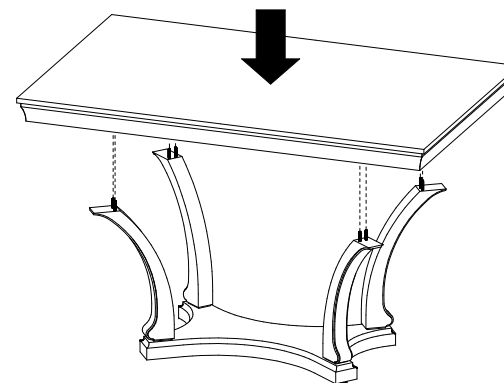

**3**

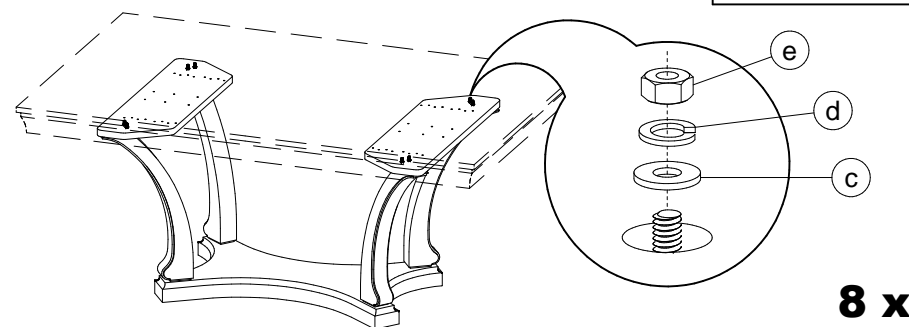
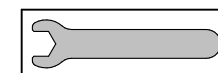

**4**

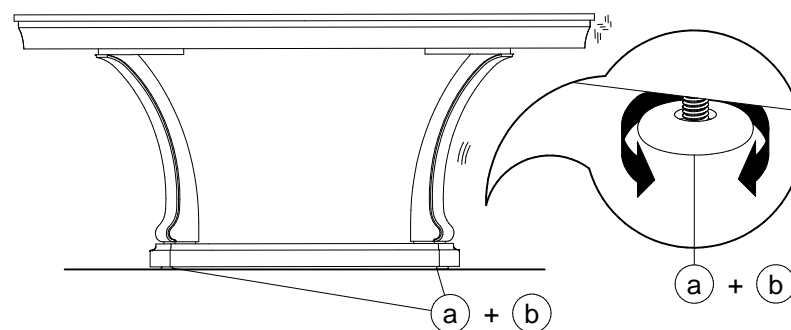

CODE PRODUIT SAC:	QUI2SACZ083	
CODE PRODUIT INFO-CLIENT:	FOP2INZTAB-1083	
REVISION:	P01	
<b>DESCRIPTION</b>	<b>NOM</b>	<b>QTÉ</b>
ECROU 5/16-18 ZINC	FOAVISZHN5-16-18	16
LOCK WASHER 5/16 ZINC	FOAVISZLW 5-16	16
WASHER 5/16 (STD) ZINC	FOAVISZWAS3-8H 5-16B	16
NIVELEUR DIA1 3/8"; 5/16-18X7/8"	QUIACCZ00701C	4
FEUTRE COLLANT DIA. 1"	QUIACCZFEUTREV23125	4