

Assembly instructions for double pedestal table

Principe d'assemblage d'une table à base double

Procedimiento de ensamblaje de una mesa con base doble

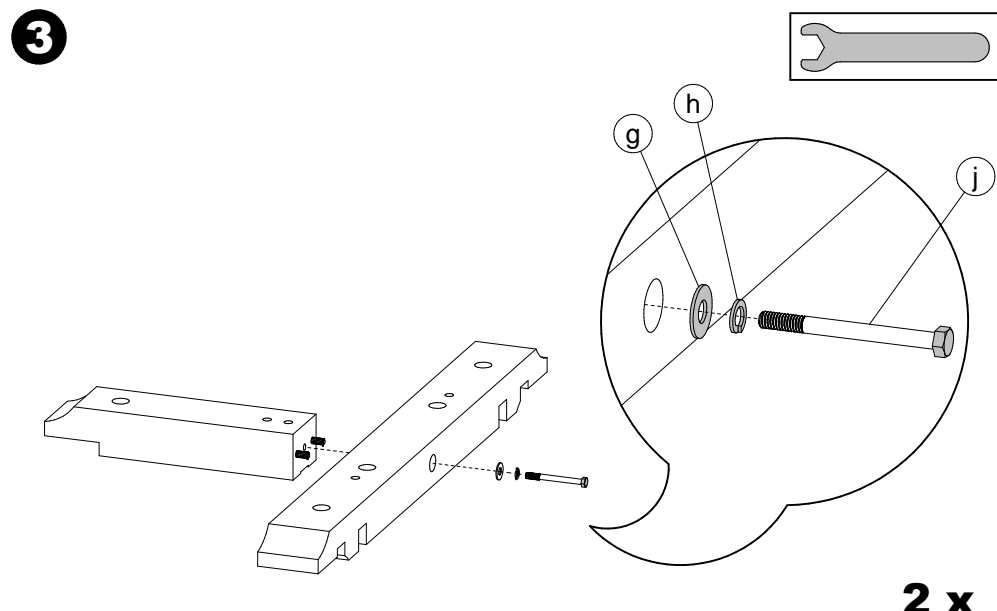
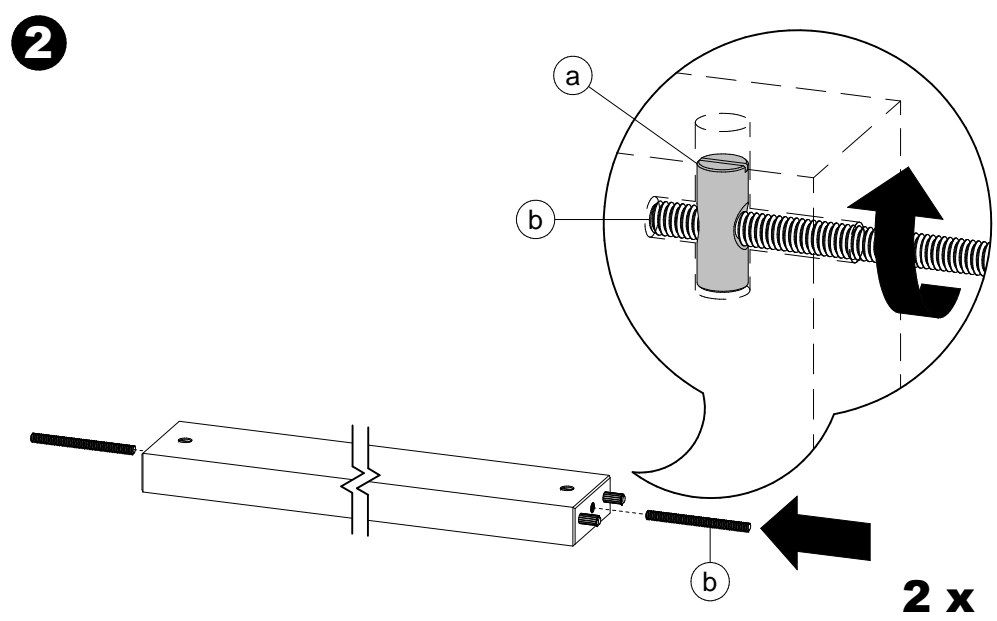
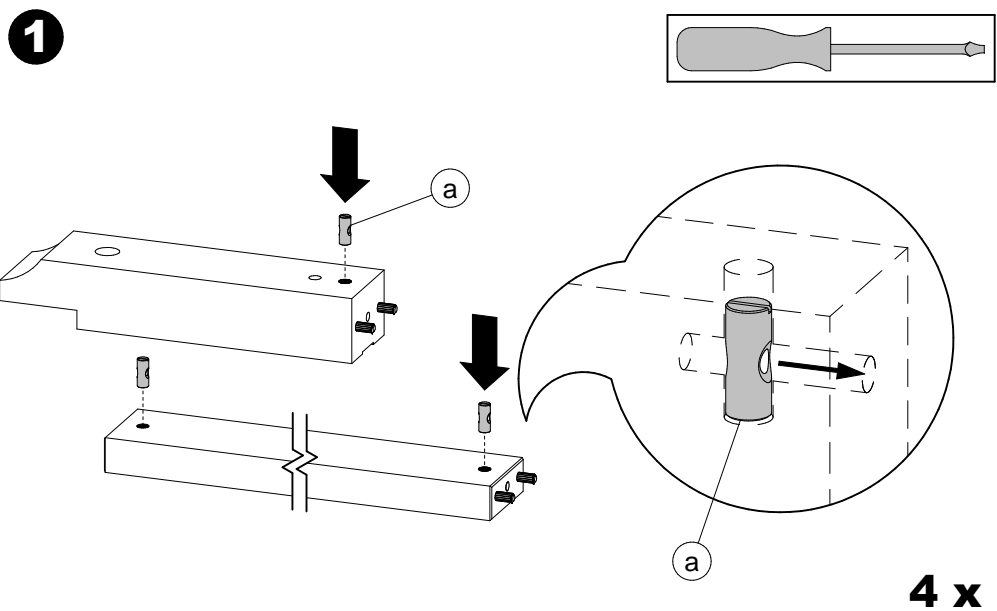
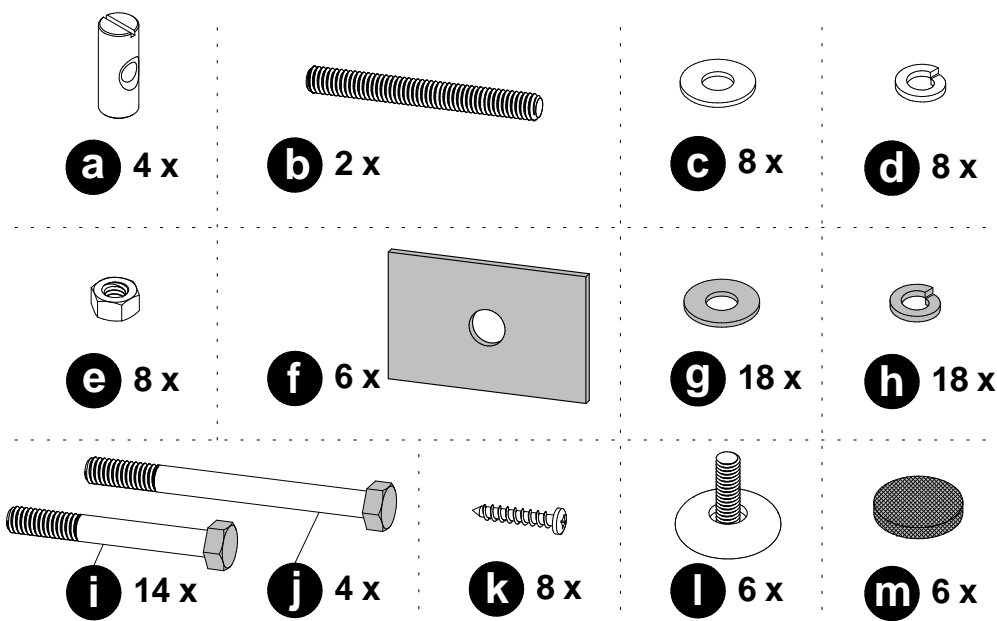

Assembly instructions for double pedestal table
Principe d'assemblage d'une table à base double
Procedimiento de ensamblaje de una mesa con base doble

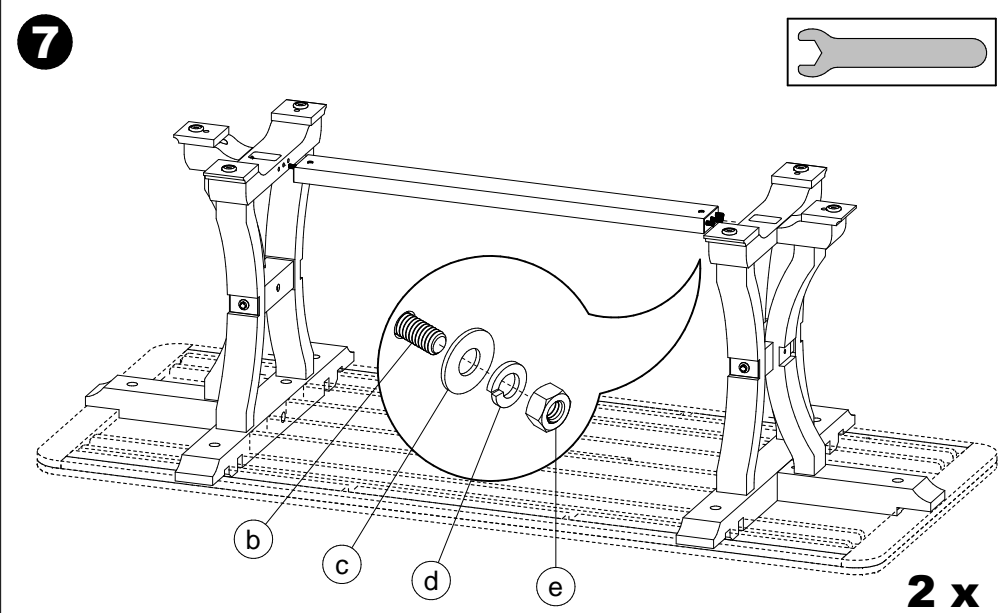
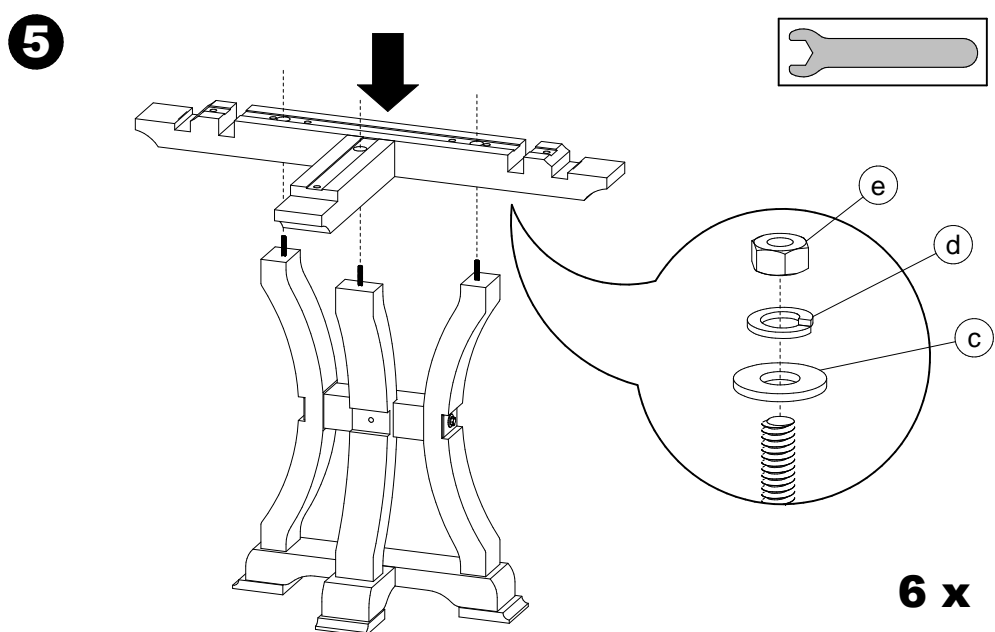
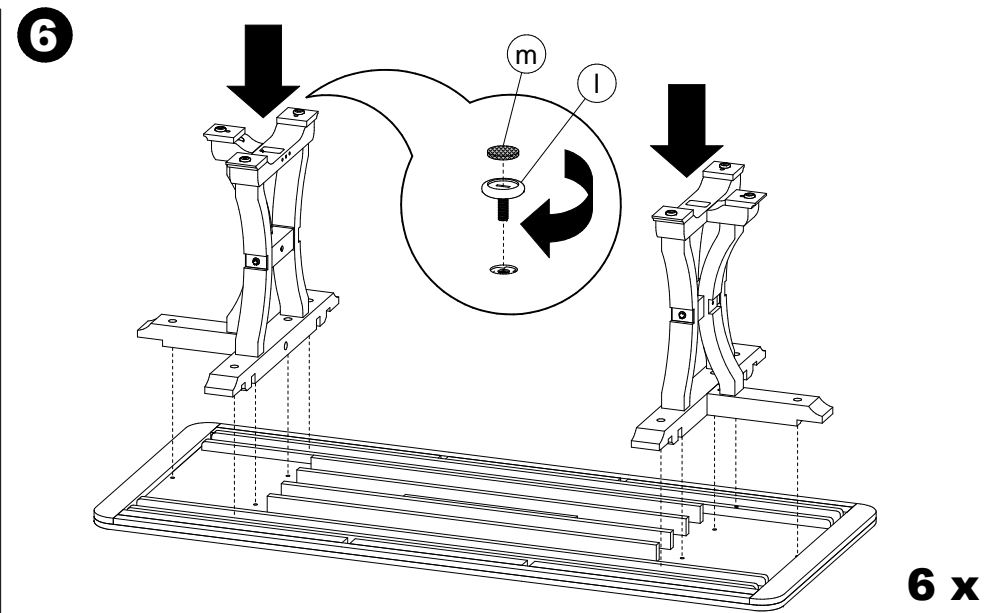
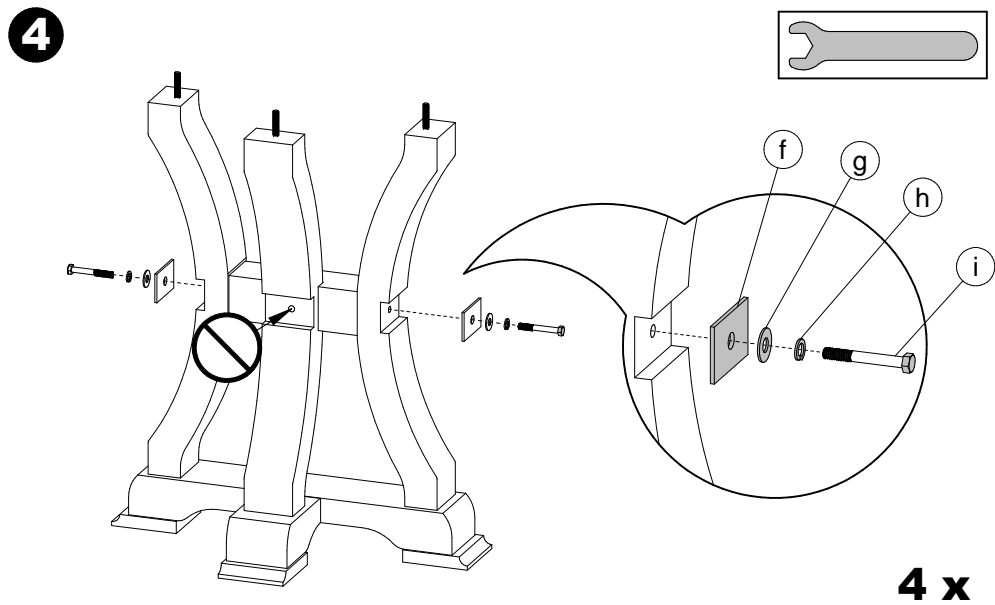

Assembly instructions for double pedestal table

Principe d'assemblage d'une table à base double

Procedimiento de ensamblaje de una mesa con base doble



Do not climb on the table.
Risk of serious injuries.
Ne pas monter sur la table.
Risque de blessures graves.
No treparse sobre la mesa.
Riesgo de herirse gravemente.

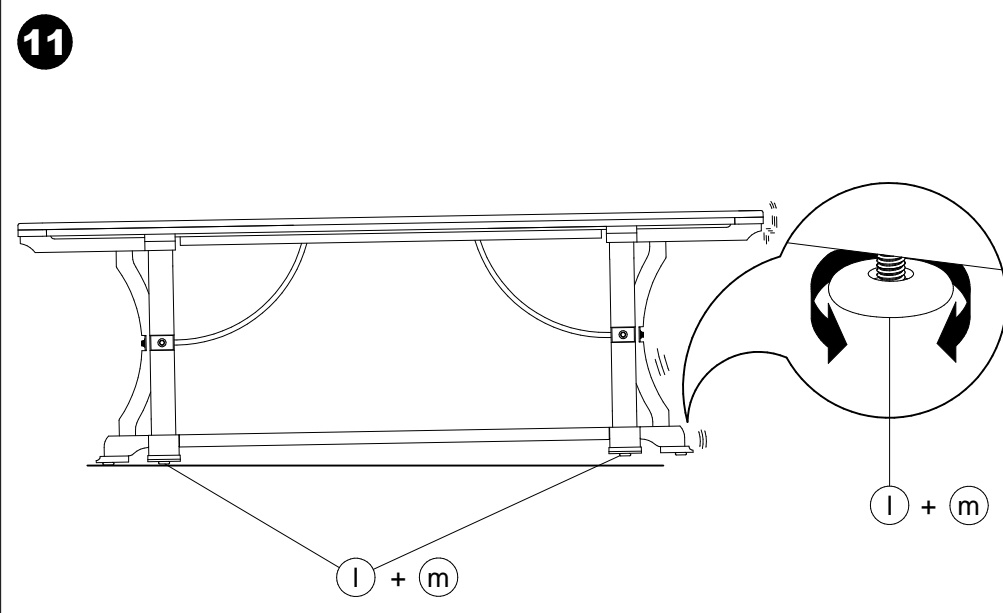
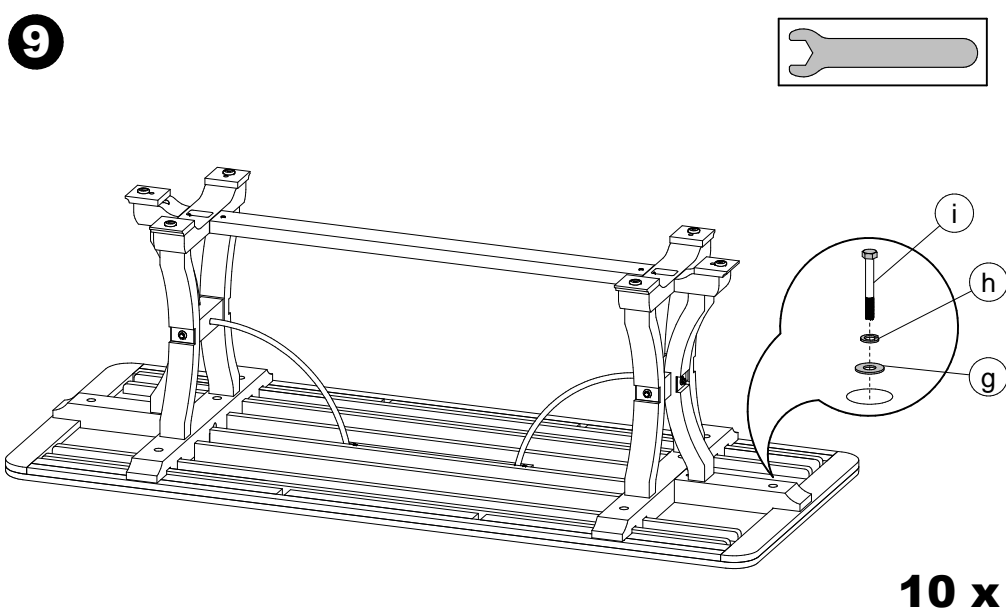
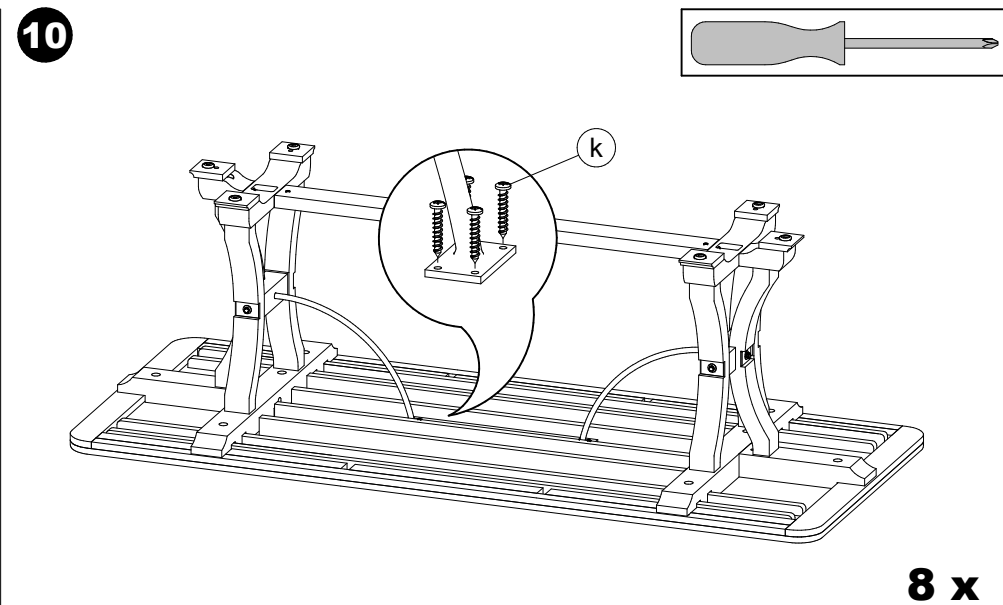
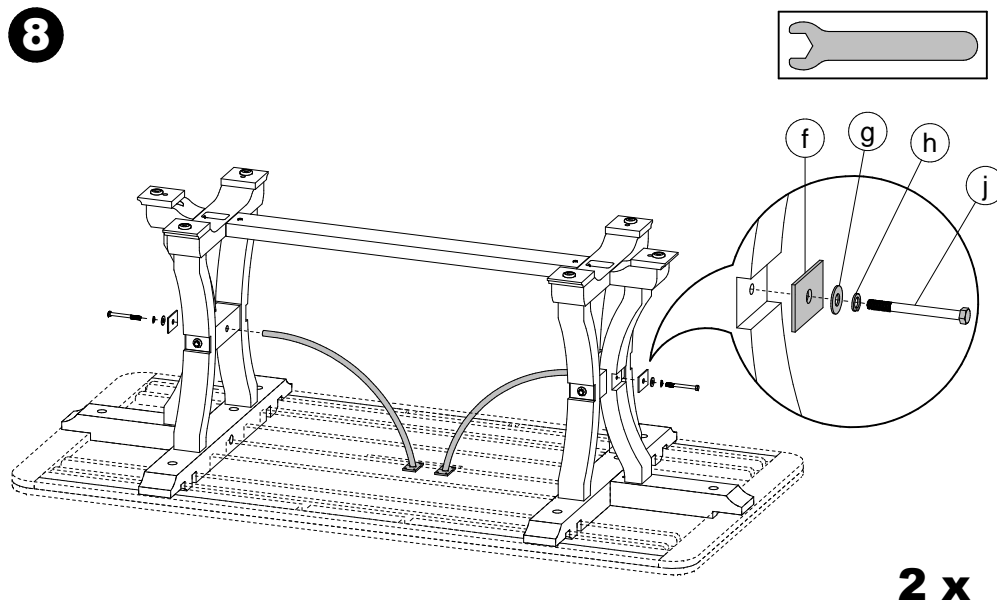

Informations internes seulement - NE PAS INCLURE CETTE PAGE DANS LE SAC

CODE PRODUIT SAC:	QUI2SACZ076	
CODE PRODUIT INFO-CLIENT:	FOP2INZTAB-1076	
REVISION:	P02	
DESCRIPTION	NOM	QTÉ
VIS #8 X 3/4" RONDE ZINC	FOAVISZ8X3-4 RND ZC	8
BOULON HEX. 5/16-18 X 2 1/2" ÉTAIN ANTIQUE	FOAVISZBH5-16-18X2 1-2PW	14
BOULON HEX. 5/16-18 X 3 1/2" ÉTAIN ANTIQUE	FOAVISZBH5-16-18X31-2PW	4
BARREL NUT 5/16-18 X 30MM	FOAVISZCD5-16-18X30MM	4
ECROU 5/16-18 ZINC	FOAVISZHN5-16-18	8
LOCK WASHER 5/16 ZINC	FOAVISZLW 5-16	8
LOCK WASHER 5/16 NOIR	FOAVISZLW 5-16 BL	18
TIGE FILETÉE 5/16-18 X 3 1/4"	FOAVISZTF5-16-18X3 1-4	2
WASHER 5/16 (STD) ZINC	FOAVISZWAS3-8H 5-16B	8
WASHER 3/8H 5/16B ÉTAIN ANTIQUE	FOAVISZWAS3-8H 5-16B PW	18
NIVELEUR DIA1 3/8"; 5/16-18X7/8"	QUIACCCZ00701C	6
FEUTRE COLLANT DIA. 1"	QUIACCCZFEUTREV23125	6
PLAQUE DÉCO ÉTAIN ANTIQUE	QUIACCCZPLAQUEFR-IMP	6