

Assembly instructions for a two bridges table

Principe d'assemblage d'une table à deux ponts

Instrucciones de ensamblaje de una mesa con dos puentes



WARNING
AVERTISSEMENT
ADVERTENCIA

Follow carefully the assembly steps. Canadel is not to be responsible for damages if the steps were not followed.
Suivre attentivement les étapes d'assemblage. Canadel ne peut être tenu responsable de bris si les étapes n'ont pas été respectées.
 Seguir atentamente el proceso de ensamblaje. Canadel se deslinda de la responsabilidad si las piezas son dañadas por no respetar el proceso de ensamblaje.

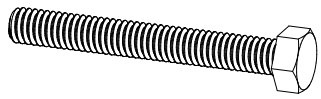

a 8 x

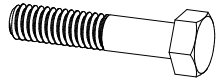

b 8 x

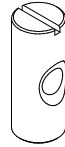

c 8 x



d 16 x



e 16 x

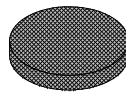

f 8 x

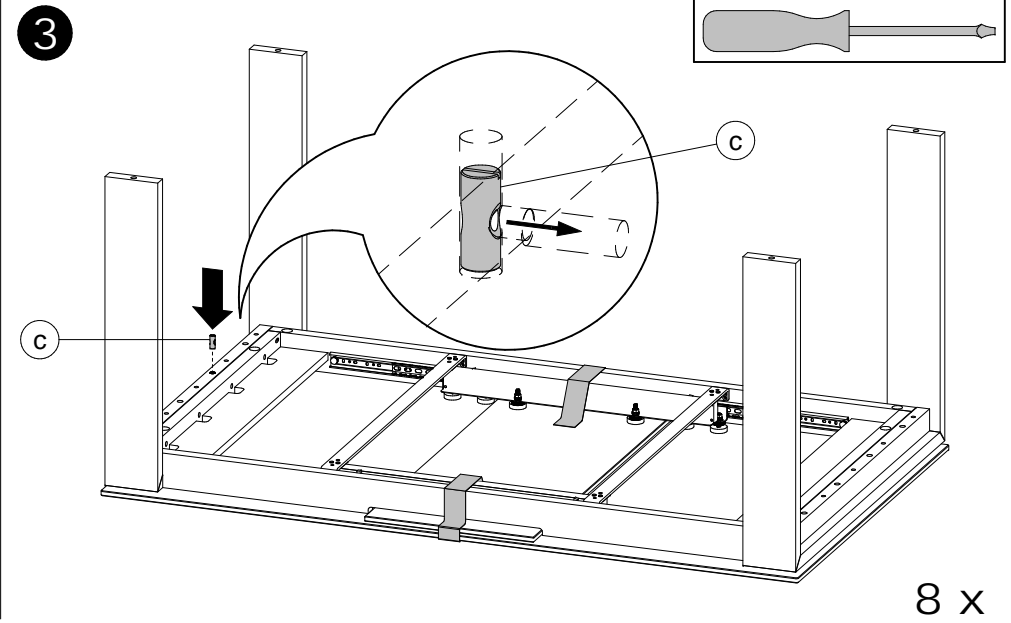
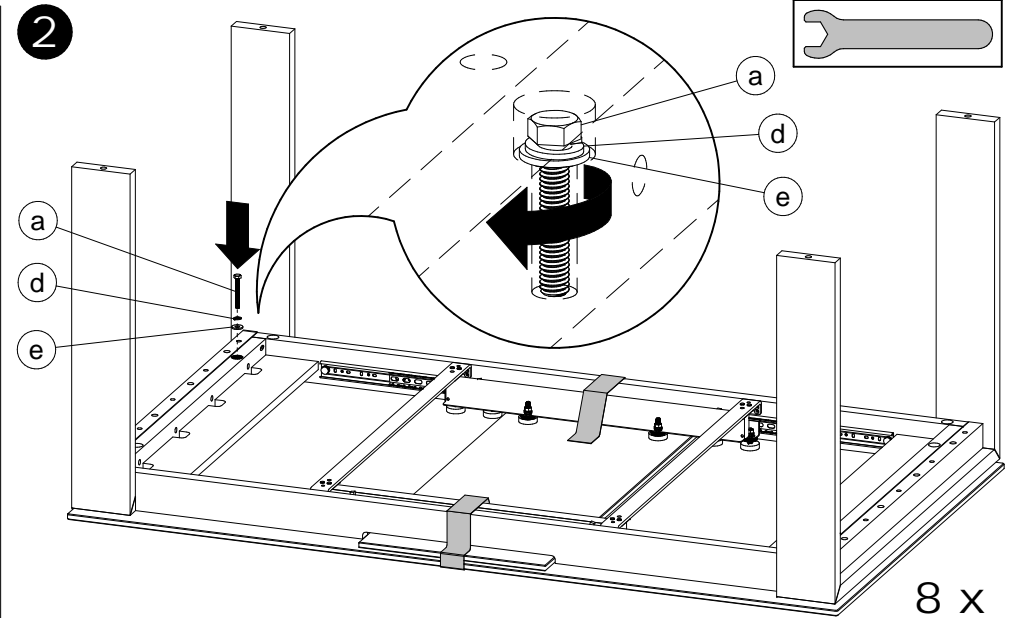
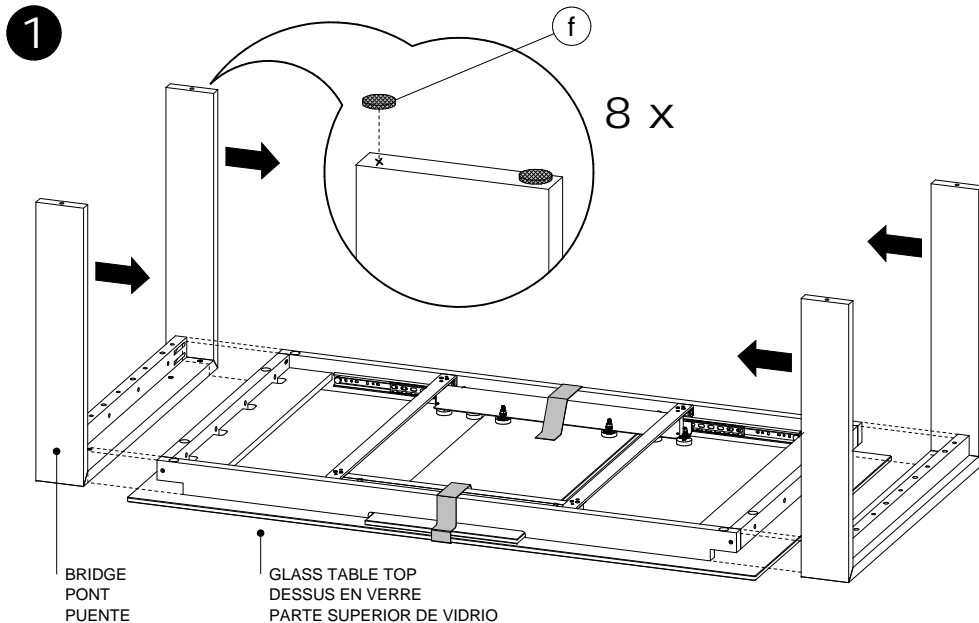

Assembly instructions for a two bridges table

Principe d'assemblage d'une table à deux ponts

Instrucciones de ensamblaje de una mesa con dos puentes



WARNING
AVERTISSEMENT
ADVERTENCIA

Follow carefully the assembly steps. Canadel is not to be responsible for damages if the steps were not followed.
Suivre attentivement les étapes d'assemblage. Canadel ne peut être tenu responsable de bris si les étapes n'ont pas été respectées.
Seguir atentamente el proceso de ensamblaje. Canadel se deslinda de la responsabilidad si las piezas son dañadas por no respetar el proceso de ensamblaje.

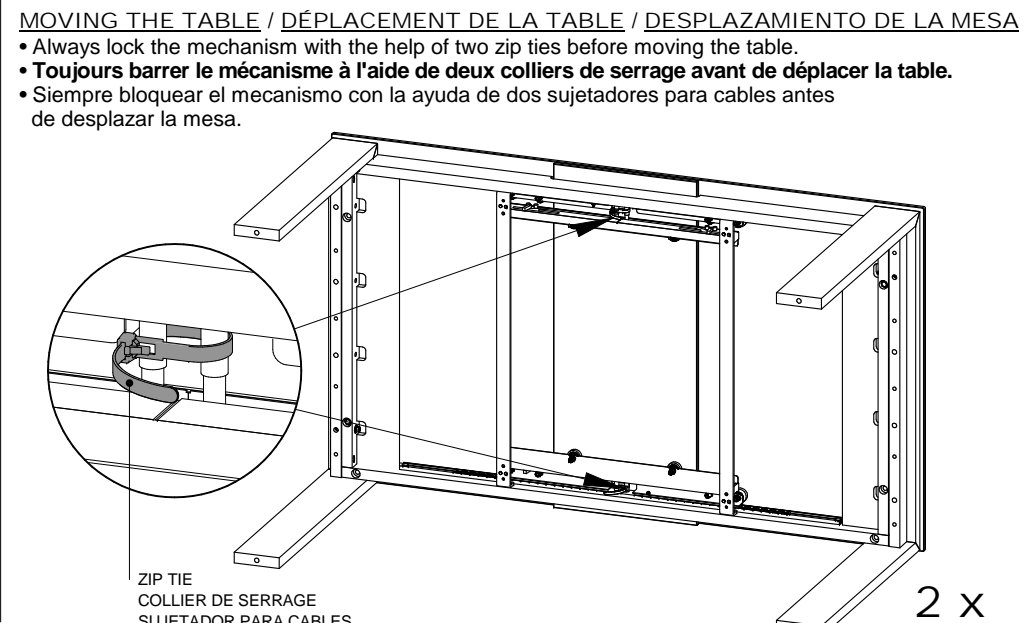
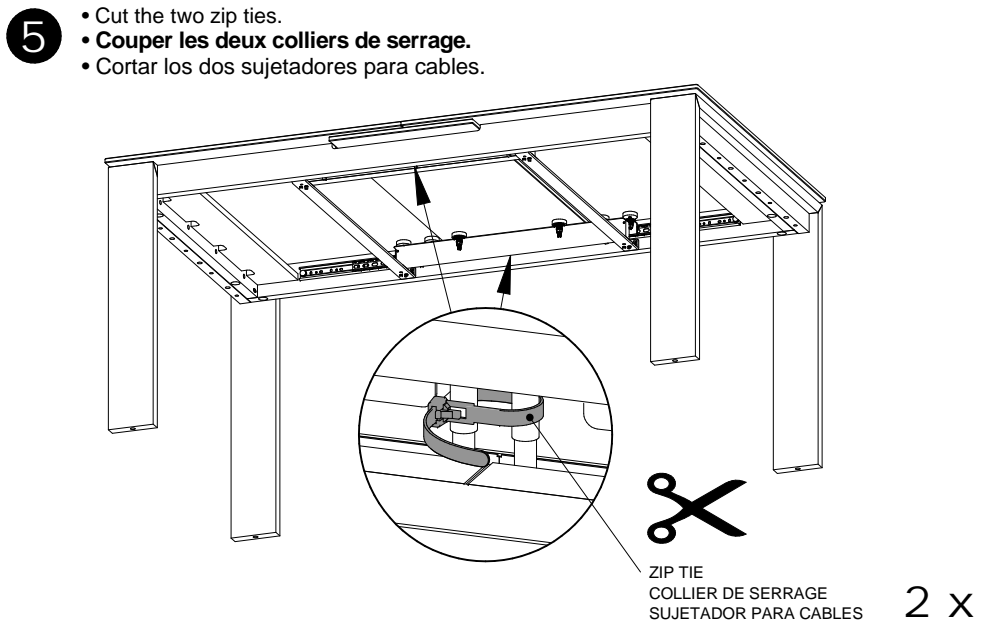
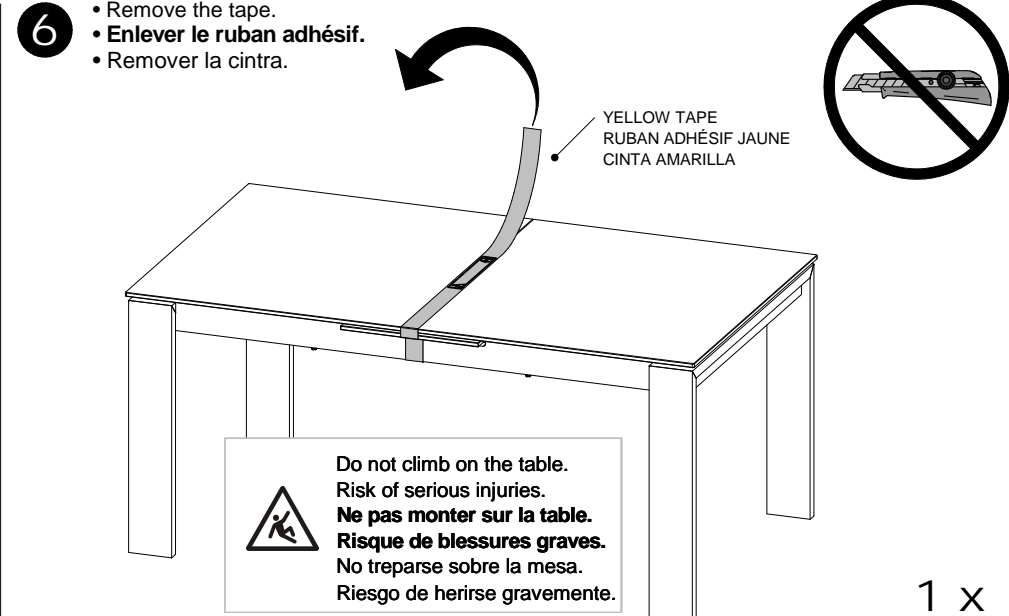
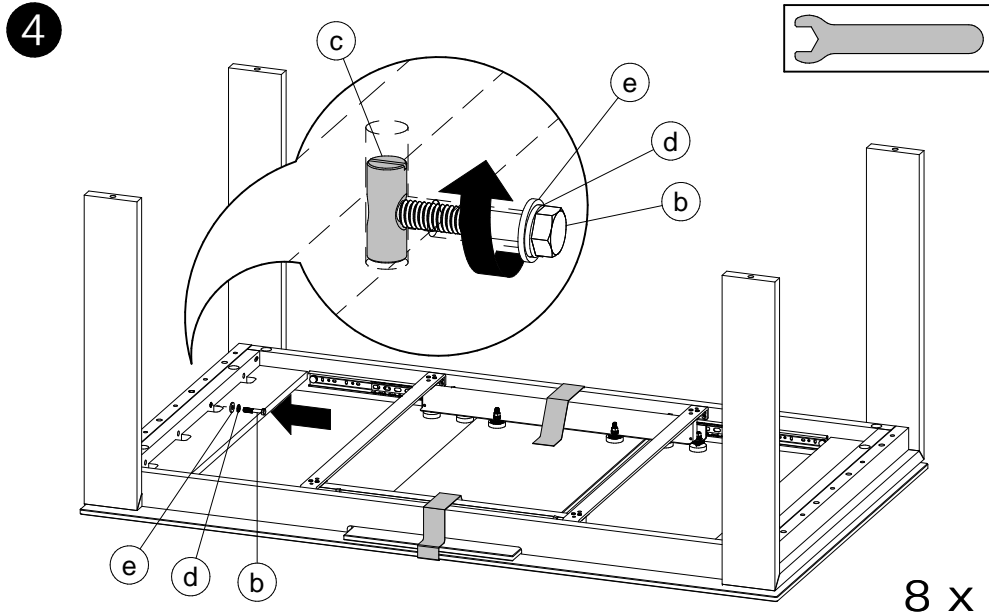

| | | |
|------------------------------|------------------------|------------|
| CODE PRODUIT SAC: | QUI2SACZ057 | |
| CODE PRODUIT INFO-CLIENT: | FOP2INZTAB-1057 | |
| REVISION: | P03 | |
| DESCRIPTION | NOM | QTÉ |
| BOULON HEX. 5/16-18 X 2" | FOAVISZBH5-16-18X2 | 8 |
| BOULON HEX. 5/16-18 X 2 1/2" | FOAVISZBH5-16-18X2 1-2 | 8 |
| BARREL NUT 5/16-18 X 30MM | FOAVISZCD5-16-18X30MM | 8 |
| LOCK WASHER 5/16 ZINC | FOAVISZLW 5-16 | 16 |
| WASHER 5/16 (STD) ZINC | FOAVISZWAS3-8H 5-16B | 16 |
| FEUTRE COLLANT DIA. 1" | QUIACCZFEUTREV23125 | 8 |