

# Assembly instructions for double pedestal table

## Principe d'assemblage d'une table à base double

### Procedimiento de ensamblaje de una mesa con base doble

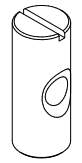

**a** 6 x

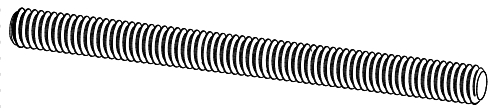

**b** 6 x

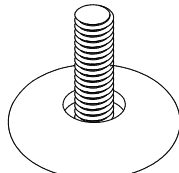

**c** 4 x

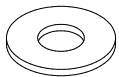

**d** 10 x



**e** 6 x



**f** 10 x

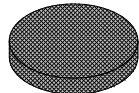

**g** 4 x

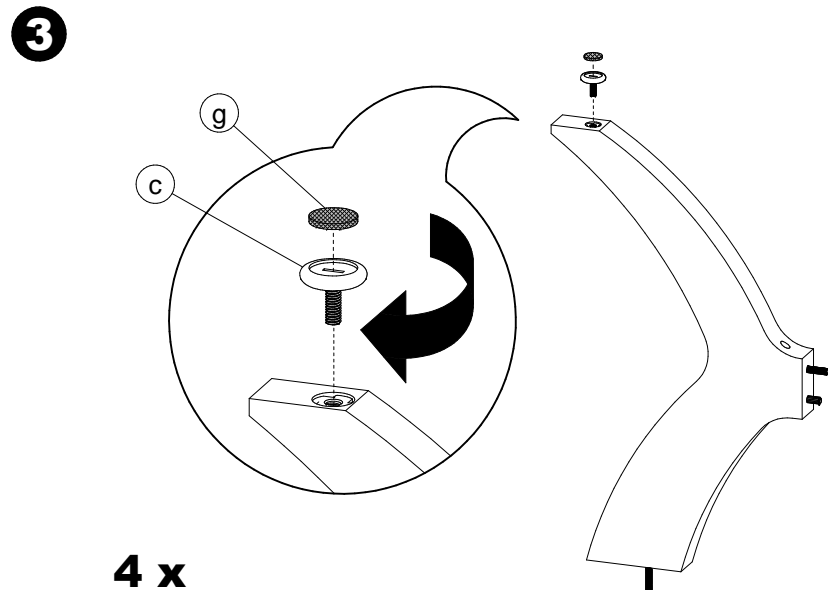
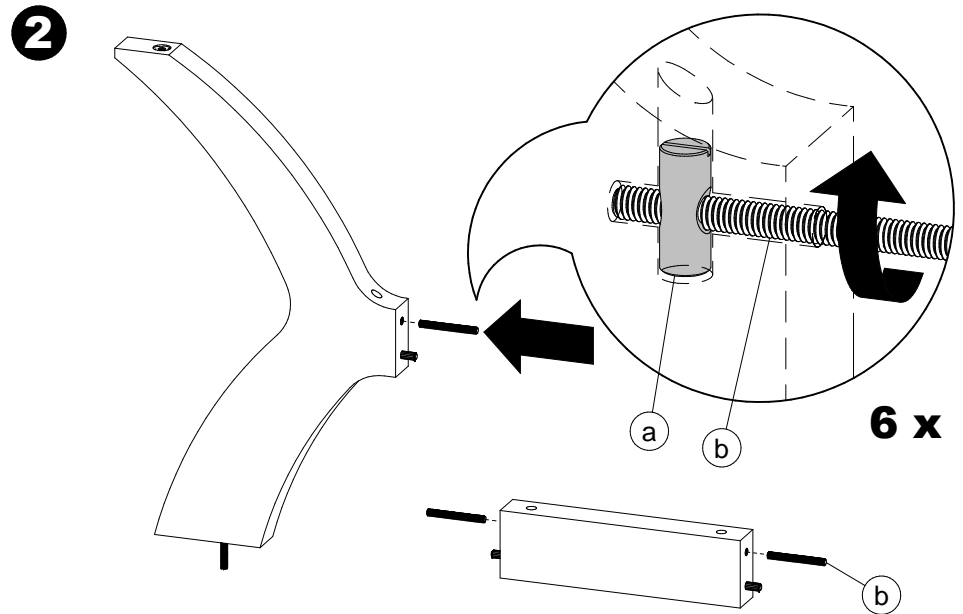
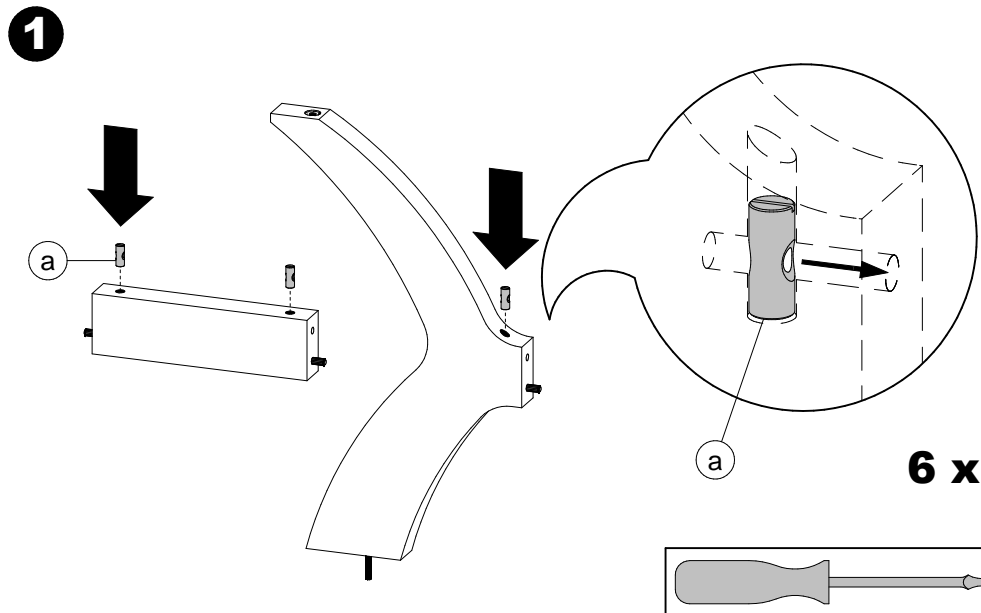

**Assembly instructions for double pedestal table**  
**Principe d'assemblage d'une table à base double**  
**Procedimiento de ensamblaje de una mesa con base doble**



Do not climb on the table.  
 Risk of serious injuries.  
**Ne pas monter sur la table.**  
**Risque de blessures graves.**  
 No treparse sobre la mesa.  
 Riesgo de herirse gravemente.

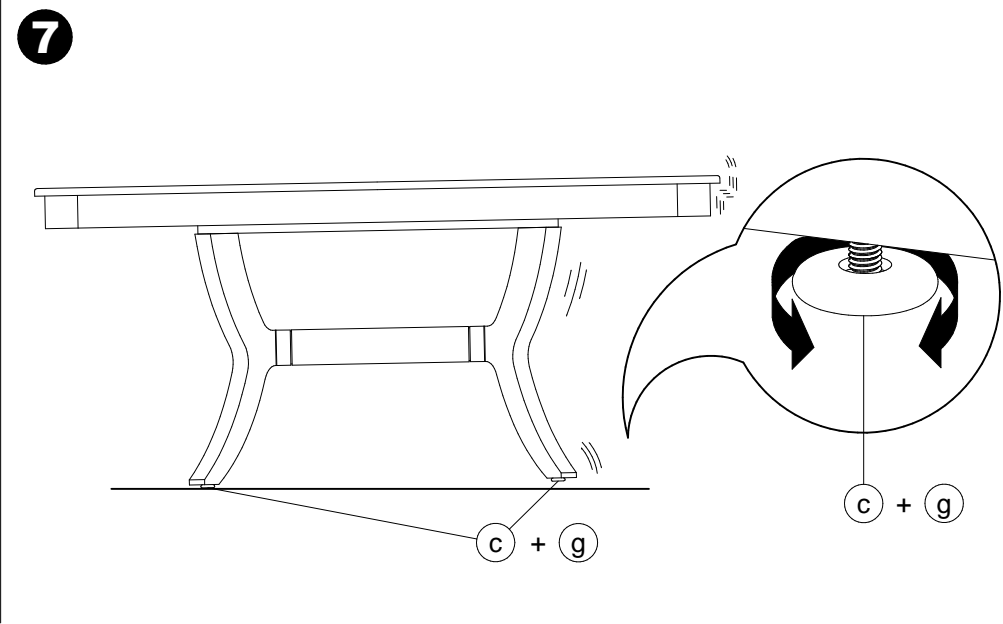
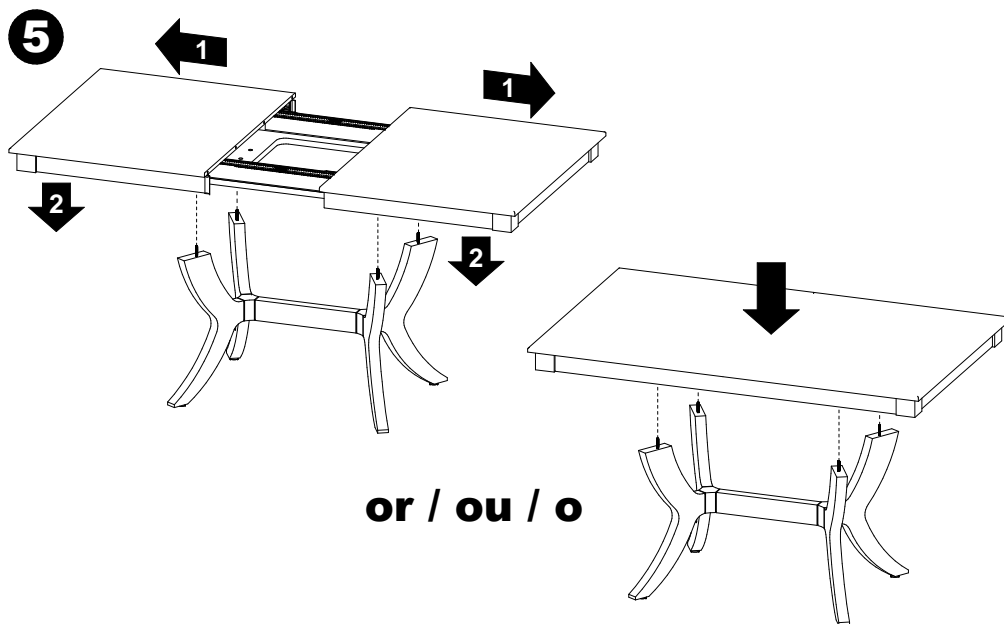
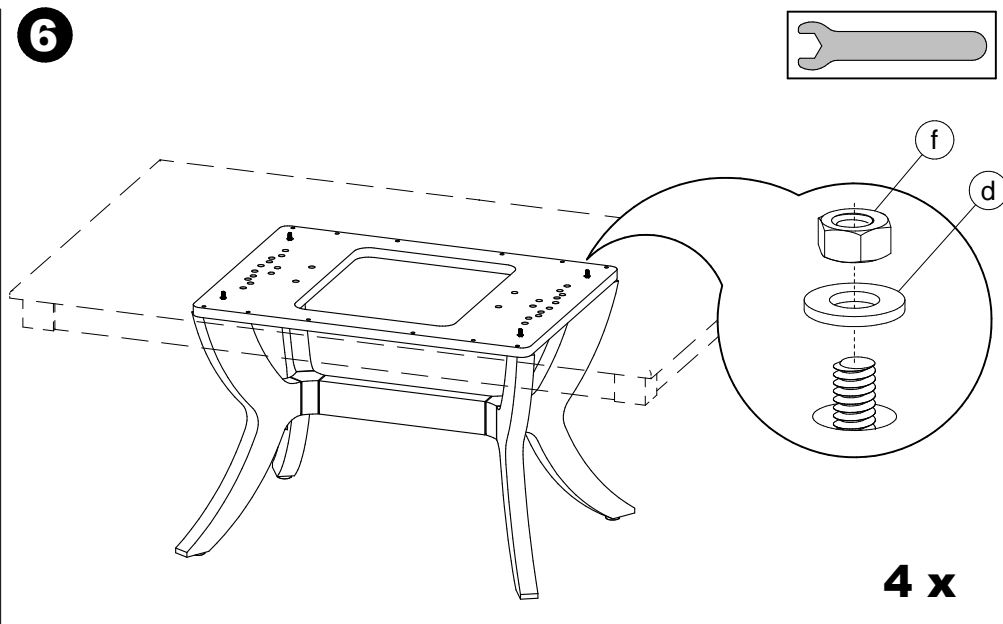
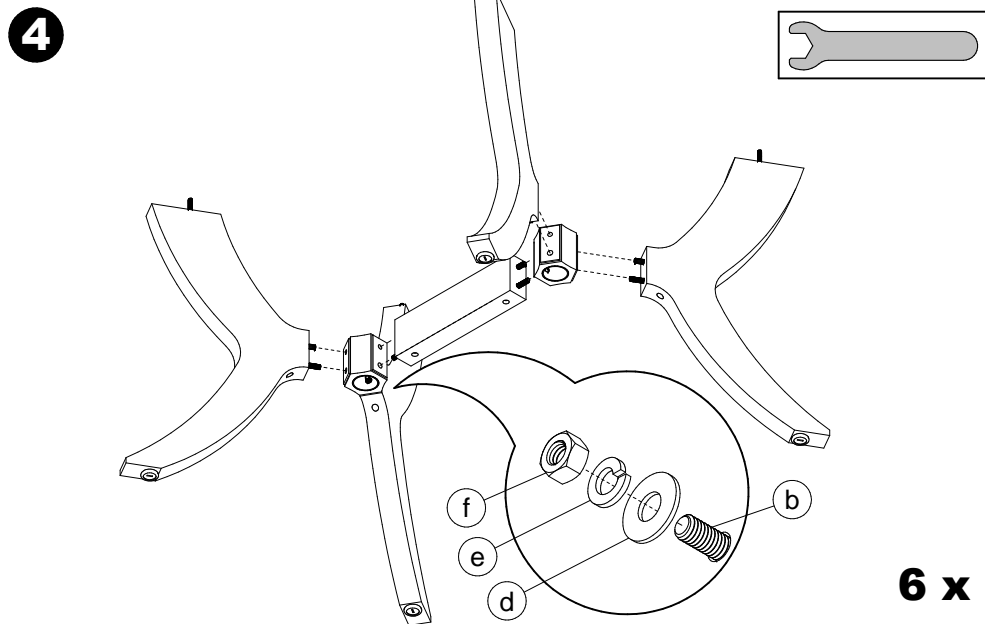

CODE PRODUIT SAC:	QUI2SACZ022	
CODE PRODUIT INFO-CLIENT:	FOP2INZTAB-1022	
REVISION:	P01	
<b>DESCRIPTION</b>	<b>NOM</b>	<b>QTÉ</b>
BARREL NUT 5/16-18 X 30MM	FOAVISZCD5-16-18X30MM	6
ECROU 5/16-18 ZINC	FOAVISZHN5-16-18	10
LOCK WASHER 5/16 ZINC	FOAVISZLW 5-16	6
TIGE FILETÉE 5/16-18 X 3 1/4"	FOAVISZTF5-16-18X3 1-4	6
WASHER 5/16 (STD) ZINC	FOAVISZWAS3-8H 5-16B	10
NIVELEUR DIA1 3/8"; 5/16-18X7/8"	QUIACCCZ00701C	4
FEUTRE COLLANT DIA. 1"	QUIACCCZFEUTREV23125	4